



WINDOW & DOOR PROTECTOR

Grip-Rite™ Window & Door Protector is a self-adhesive membrane that eliminates drafts and water leaks.

- ✓ 25 mil thick self-adhesive membrane composed of elastomeric bitumen and trilaminate woven polyethylene
- ✓ Easy-to-remove silicone treated release sheet (split-back) on the self-adhesive side

Recommended Uses:

Use it to waterproof wood, brick, concrete, and metal surfaces and to ensure a continuous air/vapor barrier on the following structures:

- ✓ Doors
- ✓ Windows
- ✓ Joints between waterproofing membranes installed without overlaps

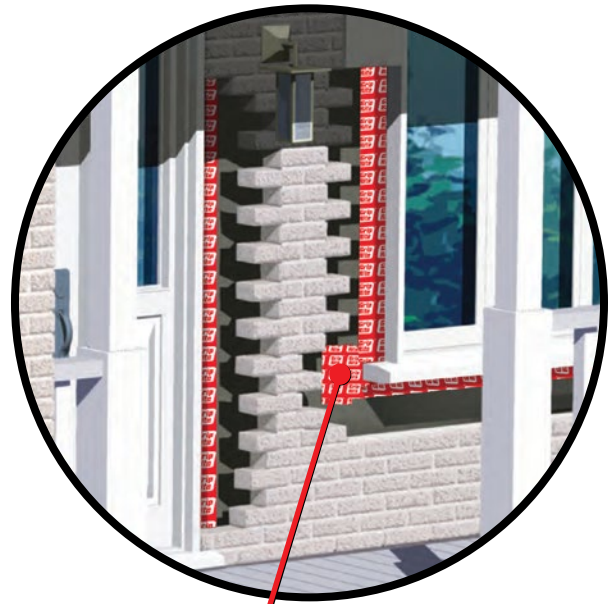

Grip-Rite Window & Door Protector

Benefits:

- ✓ Eliminates drafts and water leaks
- ✓ Resists strong winds and gusts
- ✓ Superior adhesion
- ✓ Self-sealing around nails and screws
- ✓ Red print pattern for high visibility during inspection
- ✓ Consistent thickness
- ✓ Can be sprayed with polyurethane foam
- ✓ Individually wrapped rolls; clean and easy to install
- ✓ UV resistant
- ✓ Requires no special tools
- ✓ Remains flexible at low temperatures
- ✓ Meets ASTM standards



Self-merchandising carton

SKU	Size		Rolls/ Master Carton	Approximate Coverage		
	Area	Dimensions		Per Roll	Per Box	Per Pallet
GRWRWDT4	25 ft. ²	4 in. x 75 ft.	9	25 ft. ²	225 ft. ²	8,100 ft. ²
GRWRWDT6	38 ft. ²	6 in. x 75 ft.	6	38 ft. ²	225 ft. ²	8,100 ft. ²
GRWRWDT9	56 ft. ²	9 in. x 75 ft.	4	56 ft. ²	225 ft. ²	8,100 ft. ²
GRWRWDT12	75 ft. ²	12 in. x 75 ft.	3	75 ft. ²	225 ft. ²	8,100 ft. ²
GRWRWDT18	113 ft. ²	18 in. x 75 ft.	2	113 ft. ²	225 ft. ²	8,100 ft. ²



WINDOW & DOOR PROTECTOR

Application:

- Apply to clean, dry surface free of oil, grease or residue.
- Use a sample to verify adhesion on the substrate prior to installation. If superior adhesion is required, apply a coat of Grip-Rite™ Primer prior to installing the membrane.
- Use of Grip-Rite primer over surfaces such as OSB, concrete, gypsum or fiberglass structural panels is recommended. Note: Primers take longer time to dry if installed near the prescribed installation temperatures. Plan ahead to allow enough time for primer to dry prior to installing Grip-Rite Window & Door Protector.
- Adhesion of Grip-Rite Window & Door Protector is typically satisfactory over caulks and sealants such as polyurethane, silicones or butyl, provided they are fully cured. Note: It is recommended to test adhesion to surfaces and coatings prior to full application of the membrane.
- Cover Grip-Rite Window & Door Protector with a finishing material immediately after installation.
- Polyurethane may be sprayed over Grip-Rite Window & Door Protector. Note: Membrane should be previously mechanically fastened to the substrate using a termination bar to junctions, window or door frames, endings, and on the perimeter of the building prior to installation.
- Minimum application temperature: 14°F

Restrictions:

- Grip-Rite Window & Door Protector must be protected from UV prior its installation and is not intended to be left exposed more than 90 days. In applications where the membrane could remain exposed for a longer time, use an aluminum waterproofing membrane.
- Must not be in contact with flexible PVC.
- Not designed for roof applications.

See installation guide or packaging for complete installation instructions.

Window & Door Protector Specifications		
Property	Standards	Window & Door Protector
Thickness	—	25 mil
Top face	—	Trilaminate woven polyethylene
Underface	—	Clear silicone release film
Tensile strength, MD/XD	ASTM D5147	64 / 88 lb./in.
Tensile strength, MD/XD	ASTM D412	13.1 Mpa
Ultimate elongation, MD/XD	ASTM D5147	40 / 25%
Ultimate elongation, MD/XD	ASTM D412	80 / 55%
Static puncture	ASTM D5602	90 lbf
Static puncture	ASTM E154	168 lbf
Tear resistance, MD/XD	ASTM D5601	84 / 90 lbf
Cold temperature flexibility	ASTM D5147	-22°F
Lap adhesion	ASTM D1876	6.8 lbf/in.
Peel resistance	ASTM D903	14.8 lbf/in.
Water absorption	ASTM D5147	0.1% max
Water vapor permeance	ASTM E96 (Procedure B)	0.016 perm
Air permeability	ASTM E283 (75 Pa)	5.8 · 10 ⁻⁵ ft. ³ /min · ft. ²
Resistance to sustained wind load	ASTM E330 (3000 Pa-10 s)	No delamination or variation in the air permeability
Resistance to gust wind load	ASTM E330 (100 Pa -1 h)	No delamination or variation in the air permeability

lbf= pounds-force/foot Mpa= Megapascal Specifications subject to change without notice.



800-676-7777
www.grip-rite.com
www.primesourcebp.com

© 2013 PrimeSource Building Products, Inc.

Grip-Rite™ adhesive membranes are distributed by PrimeSource Building Products, Inc.